

# RS

## TW 104.25 F 8Ω

1" Dome tweeter

Code ZH02540-8

Years of laboratory testing and listening, supported by sophisticated measurements, have led us to develop tweeters characterized by precise choices: RS tweeters use **silk domes**, a lightweight material with consistent characteristics that lends itself to various treatments to enhance its dynamic performance. The dome undergoes both internal and external treatments to create a mini-sandwich structure, preventing deformation. The **suspension** is treated with a rubber-based solution for increased stability and elasticity. The **voice coil** winding uses copper wire, the former is made of aluminium. The **magnetic circuit** uses ferrite magnet, Every element of the tweeter design concurs in the quest for the purest sound, the ultimate target for RS.

- Treated silk dome
- Damping dome treatment
- 1" voice coil with copper wire and aluminium former
- Ferrite magnet circuit
- Aluminium flange

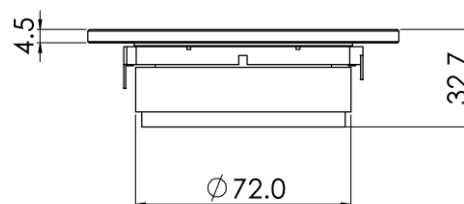
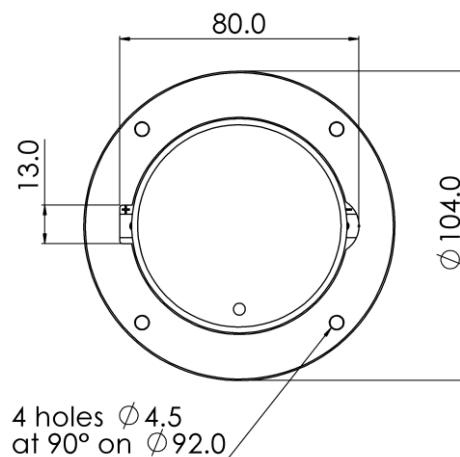

pura passione



## TW 104.25 F 8Ω

1" Dome tweeter

Code ZH02540-8

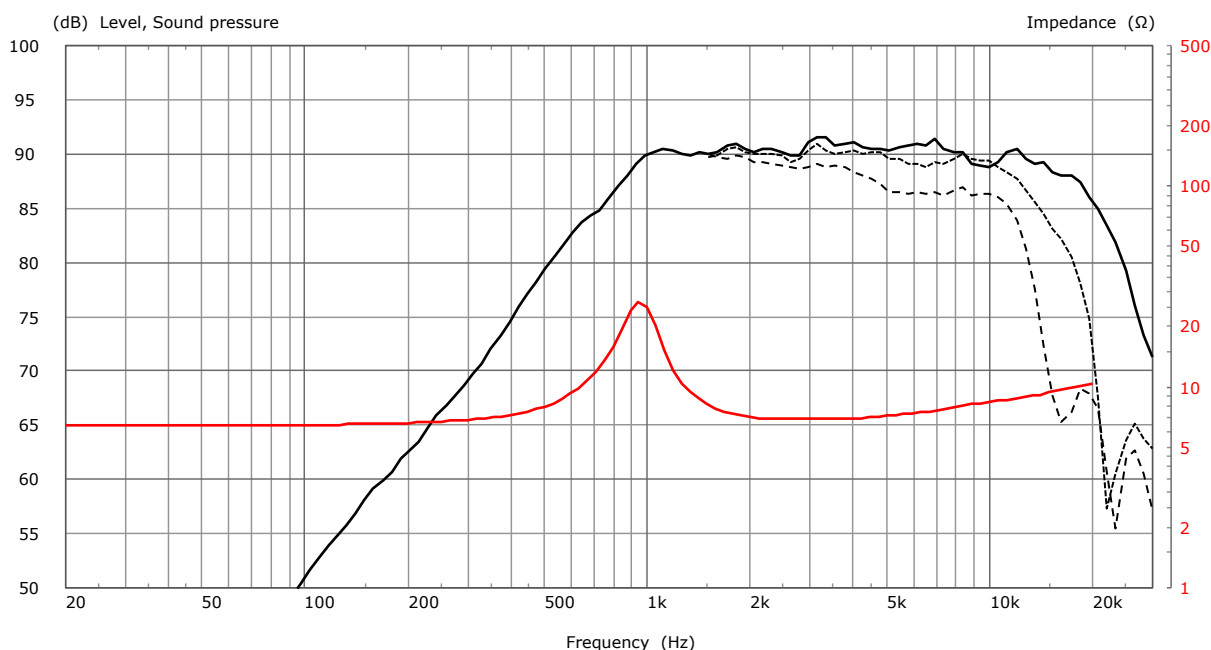

Frequency Response on IEC Baffle (DIN 45575) @ 25cm, normalized to SPL 1W,1m  
Dotted line off-axis Frequency response at 30°,60° - Free Air Impedance  
Measurement in Anechoic Chamber

### General Specifications

Nominal Diameter	104 mm
Nominal Impedance	8 Ω
Rated Power AES <sup>(1)</sup>	22.5 W
Continuous Program Power <sup>(2)</sup>	45 W
Rated Noise Power (IEC 60268-5) <sup>(3)</sup>	100W
Sensitivity @ 1W/1m <sup>(4)</sup>	91.0 dB
Voice Coil Diameter	25 mm (1")
Voice Coil Winding Depth	1.7 mm
Magnetic Gap Depth	2.0 mm
Flux Density	1.70 T
Magnet Weight	245 g
Recommended Crossover Frequency	2.5 kHz

### Thiele & Small Parameters<sup>(5)</sup>

Re	6.0 Ω	Fs	950 Hz
Qms	6.34	Qes	1.35
Qts	1.11	Mms	0.3 g
Cms	81 μm/N	Bxl	3.02 Tm
Vas	0.01 l	Sd	6.6 cm <sup>2</sup>
ηo	0.31 %	Le (1kHz)	0.04 mH

### Constructive Characteristics

Magnet	Ferrite
Voice Coil Winding Material	Copper
Voice Coil Former Material	Aluminium
Diaphragm	Treated Silk
Ferrofluid in Air Gap	No
Flange	Aluminium
Spare Part Code	ZH02540-8 SP

### Mounting Information

Overall Diameter	104 mm
Baffle Cutout Diameter	75 mm
Mounting Holes	4 holes ø4,5 on ø92 mm
Total Depth	32.7 mm
Net Weight	0.6 kg

Included: sealing gasket, fixing screws, griff-nuts

(1) Rated Power measured with 2-hour test with pink noise signal, 6dB crest factor, loudspeaker in free air, power calculated on rated Zmin. (2) Power on Continuous Program is defined as 3dB greater than the Rated Power. (3) Rated Noise Power measured with 100 hours test pink noise, 6 dB crest factor IFC60268-5 filtering. (4) Measured at 1W, 1m in axis within the frequency range. (5) Thiele & Small parameters measured with laser system. (7) Drawing dimensions: mm. Due to continuing product improvement, the features and the design are subject to change without notice.

pura passione